



MONITEQ, Inc.

MODEL CC-8521AN SINGLE DOOR ACCESS CONTROL SYSTEM

- 3, 4 or 5 digit PIN
- Compatible with large, heavy-duty "Brute" electric locks
- Automatic battery charger and low-battery warning
- Weather-proof stainless steel keypad with spy-proof shield
- Keypad cable is water-blocking, shielded type
- Meets MIL-S-901D, Grade A shock requirements
- PIN security and door monitoring and control functions
- All inputs/outputs surge protected



Crypto-Lock is a versatile, easily installed and operated single door access control system. Its microcontroller based design provides a high level of PIN security and comprehensive door monitoring functions.

The unit includes a built-in 12Vdc and 24Vdc, 2A power supply to power electric strikes and magnetic locks, eliminating the need for separate power supply units. It provides the high in-rush currents required to reliably open heavy-duty locking devices such as Von Duprin* rim latch retraction units and Sargent & Greenleaf Brute* electric locks. Continuous activation of large solenoid-operated locks is possible by a unique, switch selectable current limiter. After the lock has opened, this feature limits the current to a value that will reliably hold the lock open without damaging the solenoid.

The power supply includes a battery charger and monitoring circuit that automatically maintains external batteries in a fully charged condition and activates audible and visual warnings when the charge level is low. Two 12V, 7AH sealed lead acid batteries may be used.

The CC-8521AN is mounted on resilient shock isolators and has been tested to demonstrate compliance with MIL-S-901D, Grade A.

The stainless steel keypad includes a green LED that illuminates when the door is released. A visitor button on the keypad activates an internal 95 dB annunciator and also generates an output voltage for an external device. Effective door monitoring and control is provided by an anti-follow through feature and by door propped and forced door alarms. User code cannot be re-programmed, changed or revealed in any way from the keypad.

Installation and set-up are readily accomplished using the wiring diagram affixed inside the enclosure door and clearly labeled terminals and controls. Slide switches set the PIN length (3, 4 or 5 digits), output voltage (12 or 24 Vdc), and enable holding current limiting. Five 10-position DIP switches are used to set the PIN. The open duration time and penalty time are set by analog control knobs. The CC-8521AN can be wired to operate on either 115 or 230 Vac, 50-60 Hz.

*Von Duprin is a registered trademark of the Ingersoll-Rand Company; Brute is a registered trademark of Sargent &

Diagram

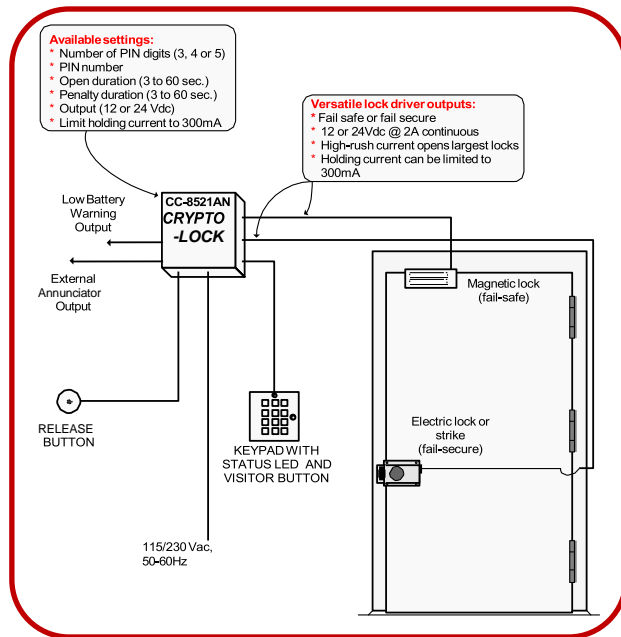

Specifications

Power Required: 115/230 Vac, 50 or 60 Hz, 60W

Output: 12 or 24 Vdc, 2A continuous

Holding Current: Can be limited to 300mA (switch selectable)

In-rush Capacity: Up to 16A

Relay Contacts: 10A, SPDT

Battery Back-up: 12 or 24 Vdc, automatic transfer and charging (batteries optional)

Battery Monitoring: Warning lamp and beep activate when batteries are low

PIN Code Length: 3, 4 or 5 digit, switch selectable

Open Duration: Adjustable, 3 to 60 seconds

Penalty Function: Invalid digits temporarily disable operation

Penalty Time: Adjustable, 3 to 60 seconds

Remote Release: Dry contact closure input

Keypad Cable: 20 ft. long, 14-conductor, #22, over-shielded, water-blocking, max. length 200 ft.

Annunciator Cable: 2-conductor, #22

Enclosure: 19 gauge steel, powder painted, gray, cam-lock and holes for padlock

Dimensions: 9.5"H x 9"W x 4.5"D

Ordering Information

Part Number: CC-8521AN

Description: Crypto-Lock single door access control system including control unit, weather-proof 10-button keypad in stainless steel spy-proof housing with visitor button and 20 ft. water-blocking, over-shielded cable, equipped with resilient shock isolation mounts to meet Mil-S-901D, Grade A shock requirements. Supplied with instruction manual and hardware.

Options and Accessories

CC-BATT 12Vdc rechargeable battery (order two for 24Vdc operation)

CC-BRUTE Heavy-duty surface mount electric lock

